



CAN Cable Installation Instructions

PART NO.

33-035

VEHICLE

Denago EV

FIRMWARE

DENAGO



■ WARNING

Wear safety glasses and insulated gloves before beginning. Ensure the battery is turned off before making any connections, and remove any metal jewelry or watches to avoid accidental short circuits.

STEP 1:

Locate the Denago Factory CAN Plug

Locate the **Denago factory CAN plug** on the golf cart (grey housing with orange interior pins). This is the connector that the supplied **Factory Sync CAN connector** will mate with.

- *Inspect both connectors for debris before connecting.*



STEP 2:

Connect the CAN Connectors

Align the supplied Factory Sync CAN connector with the Denago factory CAN plug and push firmly together until the locking tab clicks into place. The connection should feel firm with no play.

- *Give the connection a gentle tug to confirm it is fully locked.*



STEP 3:

Connect CAN Cable to Bolt Battery CAN Port

Locate the CAN port on the Bolt battery (labeled 'CAN'). Insert the CAN connector from the Factory Sync cable into the CAN port and hand tighten the collar until secure.

■ *The CAN port is located on the side panel of the Bolt battery.*



STEP 4:

Turn Battery On & Connect via Bolt USA App

Download the **Bolt USA App** from the Apple App Store (iPhone) or Google Play (Android). Then turn the battery on by pressing and holding the power switch. Once active, open the **Bolt USA App** on your mobile device, connect via Bluetooth, scroll to the bottom of the Status Display and tap **Update** under UPDATE FIRMWARE.

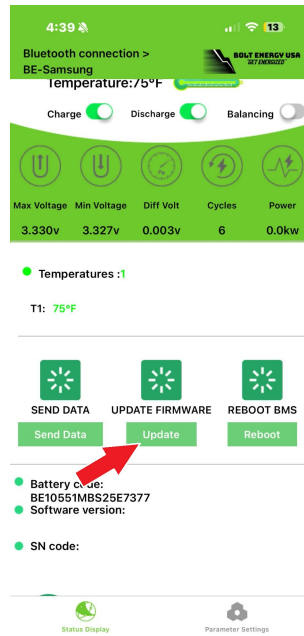

STEP 5:

Enter Firmware Code & Complete Installation

Type **DENAGO** in the field and tap **Agree**. The app will display the firmware version — tap **Update** to begin. The update takes approximately 2 minutes. Keep the app open and on the front screen at all times — do not let the screen lock or switch apps as this could damage the battery management system.

Once the firmware update is complete the battery will restart automatically. The Denago EV will now communicate with the Bolt battery via CAN bus and the cart will be fully operational.

■ If the cart does not respond, verify all connections and confirm firmware DENAGO was installed correctly.

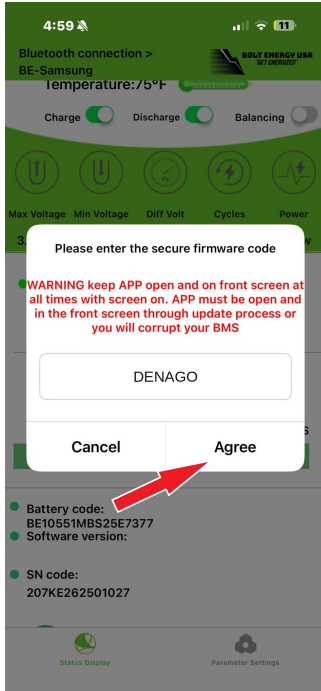

Enter code & tap Agree

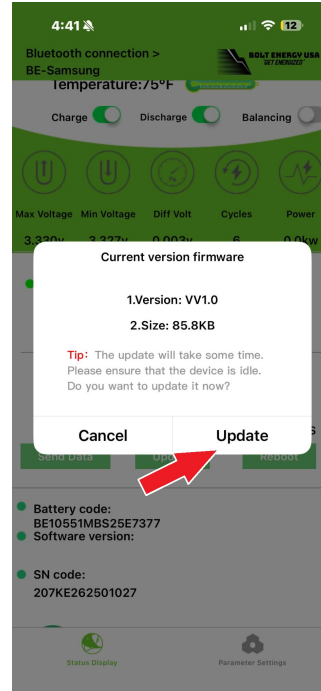

Tap Update to confirm